



PREMIUM LIST

Entries close at 5:00pm WEDNESDAY, September 18, 2024
E-mail entries WILL NOT be accepted! Separate Entry Form for each dog for each day! GATE ENTRIES DUE AT 8:30am day of trial.

Field Trial Secretary
Christine Canard
8132 Colfax Ave S. Bloomington MN 55420
612-395-1110 ccanard@gmail.com

Directions to the Field

From either north or south on I-35, take exit 81 east (County Road 70). Follow 70 east about 3 miles to Cedar Avenue. Turn left on Cedar about 1/8 mile to Highway 50. Turn right (east) on 50 to Farmington. Follow the signs to the Dakota County Fairgrounds.

The South Field is located on the West side of the Fairgrounds.

Accommodations

Camping with hook-ups at the Dakota County Fairgrounds. There is self pay box near the office. **Reservations are required.** Please call 651-463-8818 to make a reservation during business hours. Leave a message if no one answers. Or email the Fairgrounds at fair@dakotacountyfair.org. Toilet facilities are available on the North end of the Fairgrounds. **There is no car camping unless you are in the campgrounds and have paid the camping fee.**

Motel 6 I-35 and County Road 70, **Lakeville** (952) 469-1900. 15 minutes or less from site. Use AKC's number CPM64DOG when making a reservation to get pet limit removed.

America's Best Value Inn & Suites 1420 Riverview Drive, **Northfield**, MN 55057.(507) 663-0371 About 10 miles south of the Fairgrounds along Highway 3. Does allow pets, but there is an additional pet charge.



ASFA All-Breed & LCI Field Trial~Region 5 September 21 & 22, 2024



Dakota County Fairgrounds – South Field
4008 - 220th Street West Farmington, MN 55024

Cell Phone at field: 612-396-1110 or 651-341-6375

ENTRY FEE: **\$20.00** for first dog entered each day,
\$17.00 for EACH additional dog from the same household each day.
Gate entries \$27 each dog.
LCI Entries limited to 20 dogs

ROLL CALL & INSPECTION 9am
All Breeds and Stakes – No Exceptions

The American Sighthound Field Association has granted permission to hold this event under the ASFA Rules & Regulations.

Sam Duryee
ASFA Scheduling



President: Christine Canard Vice President: Robin Exsted
 Secretary: Robin LaFortune Treasurer: Kay Nierengarten
 Directors: Juliet Carlson, Laurie Erickson, Barb Hearley, Karyn Krahn, and Marilyn Rew
 ASFA Delegate: Christine Canard

Judges & Assignments

Vicki Fagre Stroetz, Stacy, MN Claudia Miller, Arvada, CO Kent Standerford, Omaha, NE

September 21-22, 2024	Afghan	Azawakhs	Basenji	Borzoi	Cirneco	Chart Polski	Galgo	Greyhound	Ibizan	Irish wolfhound	Italian Grey	Magyar	Peruvian	Pharaoh	Port Podengo	Port Pequeno	Ridgeback	Saluki	Scott Deer	Singles	Silken	Sloughi	Whippet	LCI - ALL	
Saturday	AH	AZ	BA	BZ	CE	CP	GE	GH	IB	IW	IG	MA	PO	PH	PP	PQ	RR	SA	SD	SN	SW	SL	WH	LCI	
Vicki Fargre-Stroetz		x	x	x	x	x	x	x	x	x	x	x	x	x											
Claudia Miller	x	x	x	x	x	x	x	x	x	x	x	x	x	x	x	x	x	x	x	x	x	x	x	x	x
Kent Standerford	x															x	x	x	x	x	x	x	x	x	x
Sunday	AH	AZ	BA	BZ	CE	CP	GE	GH	IB	IW	IG	MA	PO	PH	PP	PQ	RR	SA	SD	SN	SW	SL	WH	LCI	
Vicki Fargre-Stroetz																x	x	x	x	x	x	x	x	x	x
Claudia Miller	x	x	x	x	x	x	x	x	x	x	x	x	x	x	x	x	x	x	x	x	x	x	x	x	x
Kent Standerford	x	x	x	x	x	x	x	x	x	x	x	x	x	x											

Field Trial Chair: Karyn Kran

**Field Trial Secretary: Christine Canard 612-396-1110 ccanard@gmail.com
 8132 Colfax Ave S, Bloomington, MN 55420**

Lure Operators: Barb Steinlage, Mark Shubert, Kent Standerford, Emma Broadnax, Bob Meyer

- **TRIAL HOURS: 8:00am until after ribbons are awarded.**
- **SUBSTITUTIONS (same owner) until 8:30 am day of trial.**
- **ENTRIES WILL NOT BE ACKNOWLEDGED by phone or mail**

RIBBONS or ROSETTES will be offered for all placements.

First Prize - Blue Next Best Qualified - Green
 Second Prize - Red High Scoring Singles Stake Winner – Navy & Gold
 Third Prize - Yellow Best of Breed – Purple & Gold Rosette
 Fourth Prize - White Best in Field – Red, White & Blue Rosette
 Other prizes may be offered by the GTCWC and Friends of the GTCWC.

ELIGIBLE BREEDS AND REGISTRIES Only purebred Afghan Hounds, Azawakhs, Basenjis, Borzoi, Cirneco dell’Etna, Greyhounds, Ibizan Hounds, Irish Wolfhounds, Italian Greyhounds, Pharaoh Hounds, Rhodesian Ridgebacks, Salukis, Scottish Deerhounds, Silken Windhound, Sloughis, and Whippets may be entered in the regular stakes. Provisional breeds may be entered in the Provisional Stake or the Singles Stake.

Provisional breeds currently include purebred Chart Polski, Galgo Español, Magyar Agar, Peruvian Inca Orchid, Portuguese Podengo (Pequeno), Portuguese Podengo (Medio & Grande), and must be individually registered with the appropriate registry. All entries shall be individually registered with the AKC (including ILP & PAL), the NGA, the UKC, the FCI, an ASFA-recognized foreign or ASFA Board approved registry or possess a CRN from the SPDBS. A photocopy of acceptable registry must be submitted with each hound.

Stakes Offered

REGULAR STAKES OFFERED

OPEN STAKE: Any eligible sighthound, excluding ASFA Field Champions of record that has not met the certification requirements.

FIELD CHAMPION STAKE: Any ASFA Field Champion

VETERAN STAKE: Any eligible hound whose age is at least six years, except Irish Wolfhounds whose age shall be at least five years, and Afghan Hounds, Ibizans, Rhodesian Ridgebacks, Salukis and Whippets whose age shall be at least seven years. That has obtained an ASFA certification, AKC QC, or other qualifying waivers prior to the closing date. A copy of the certificate MUST be submitted with the entry forms. Points go toward V-FCh or V-LCM titles.

PROVISIONAL STAKE: Any eligible sighthound of a Provisional breed that has met certification requirements. Not eligible to compete in Best of Breed or Best in Field.

SINGLES STAKE: Any eligible sighthound including those disqualified to run in other stakes. Each hound runs alone. Not eligible for Best of Breed or Best in Field. Hounds are eligible to earn TCP and CPX titles from the Singles stake. Provisional breeds are not eligible for these titles.

Best in Field will be offered both Saturday and Sunday.

LURE CHASING INSTINCT (LCI) STAKE: Open to NON sighthounds and sighthound mixes. Entries shall be individually registered with the AKC (including ILP & PAL), the UKC, the FCI, an ASFA recognized foreign or ASFA Board approved registry, possess a CRN from the SPDBS. Or, dogs without a recognized registry number may obtain an ASFA identification number for a \$10 registration fee at time of entry. Small Open: for dogs 17.5" or less at the withers and / or brachycephalic ("flat-faced") dogs who have not achieved the title of LCC.

Small Excellent: for dogs 17.5" or less at the withers and/or brachycephalic dogs who have achieved the title of LCC.

Small Veteran: for dogs 17.5" or less at the withers and/or brachycephalic dogs over the age of 7 years.

Large Open: for dogs over 17.5" at the withers who have not achieved the title of LCC.

Large Excellent: is for dogs over 17.5" at the withers who have achieved the title of LCC.

Large Veteran: for dogs over 17.5" at the withers who are over the age of 7 years.

SIGHTHOUND MIX Open: for dogs with a sighthound breed in its background who have not achieved the title of LCC.

SIGHTHOUND MIX Excellent: for dogs with sighthound breed in its background who have achieved the title of LCC.

SIGHTHOUND MIX Veteran: for dogs with sighthound breed in its background over the age of 7 years.

When running as a stake within a regular ASFA trial, Small will run 50% of the ASFA course as laid out for the sighthounds up to a maximum of 400 yards. All other stakes will run the full ASFA laid out course length.

Conditions of Entry (applies to all stakes)

- Hounds/dogs must be one year of age or older on day of trial.
- Stakes will be split into flights by public random draw if the entry in any stake is 20 or more.
- Females in season, lame hounds/dogs and those that are unfit to course will be excused at roll call.
- Hounds with breed disqualifications that are entered in regular breed stakes will be excused at roll call.
- Spayed, neutered, monorchid or cryptorchid without breed disqualifications may be entered in regular hound breed stakes.
- Hounds with breed disqualifications are eligible to enter Singles Stake.

- Hounds/dogs not present at the time of roll call will be scratched *without refund*.
- All hounds/dogs will be run twice unless excused, dismissed or disqualified.
- All hounds/dogs will run in trios if possible, or braces (except in Singles and LCI stakes).
- A separate entry form is required for each hound/dog for each day.

Other Information

- Battery powered continuous loop lure machine will be used. Backup equipment will be available.
- Lure will consist of highly visible plastic strips.
- Exhibitors are requested to not bring bitches known to be in season to the field.
- There will be a \$5.00 fine assessed for any loose hound not participating in the course.
- Any person may, upon reasonable complaint, be asked to leave the grounds of the field trial by the Field Trial Committee.
- The field is partially fenced.
- Children must be under control of their parents or guardians at all times.

FOR ALL FIRST TIME ENTRIES

- Include a copy of your dog's registration papers
- Include your "ASFA HOUND CERTIFICATION" form or ASFA approved proof of certification if your hound is entering the open or veteran stake for the first time.
- Retain a copy for your records
- Some loaner slip lead and blankets are available to borrow

Course Plans

The course will be reversed for the finals, runoffs and Best of Breed. GTCWC reserves the right to alter the course plan as required by weather and/or field conditions on the date of the trial. Terrain is grassy.

Water and some shade are available at the field.

Emergency Veterinarian

14690 Pennock Avenue,
 Apple Valley, MN 55124
 Friday 6 pm - Monday 8 am
 (952) 953-3737



South Metro
 Animal
 Emergency Care

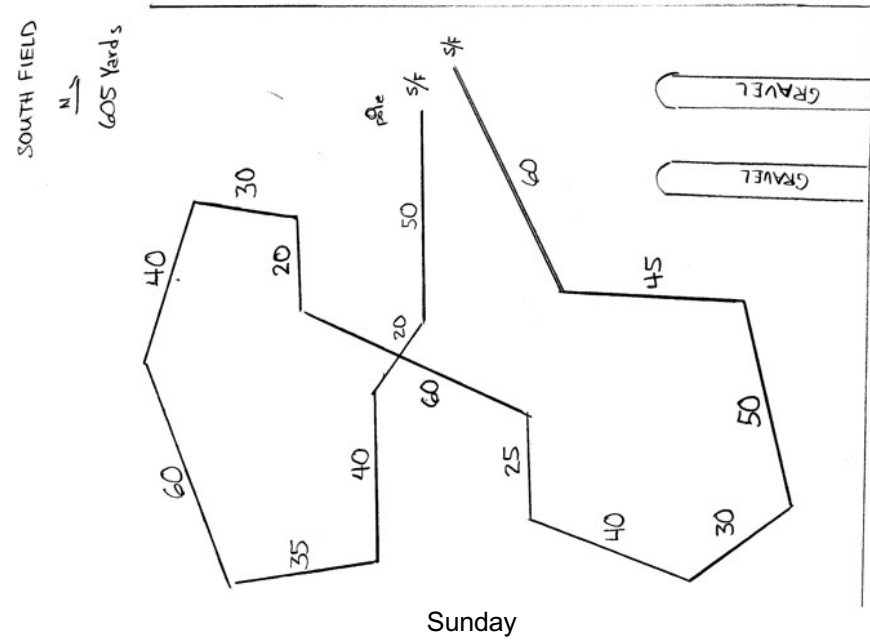
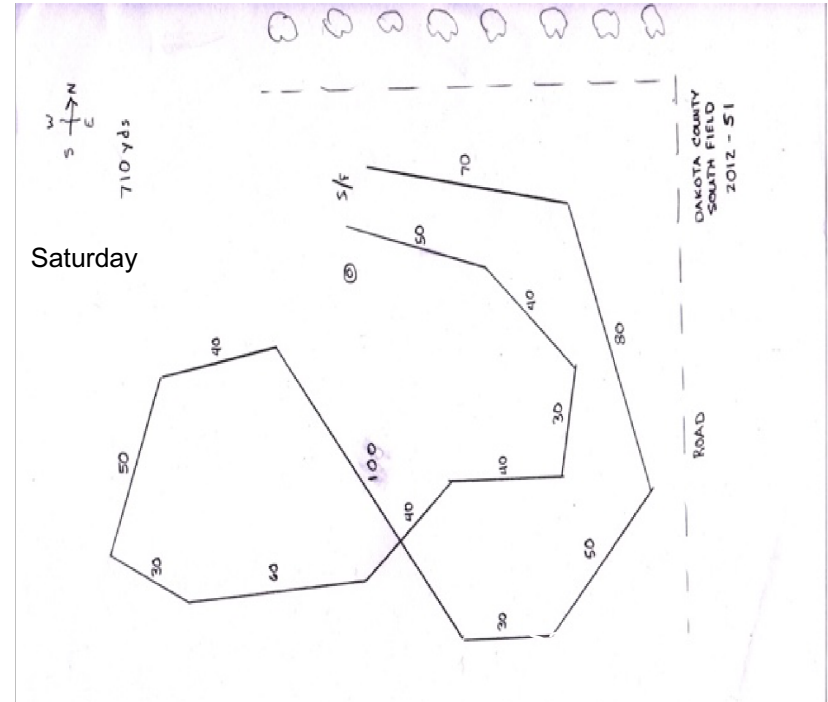

OFFICIAL AMERICAN SIGHTHOUND FIELD ASSOCIATION ENTRY FORM

GREATER TWIN CITIES WHIPPET CLUB **Septemer 21 & 22, 2024**

Entry Fees: \$20 first entry; \$17 second entry same household

Entries close **5PM, Wednesday, September 18, 2024**

Christine Canard 8132 Colfax Ave S. Bloomington, MN 55420

Make payment by check payable to GTCWC

Saturday 9/21/2024

Fee Paid _____ The Field Secretary cannot accept conditional, unsigned, incomplete, or unpaid entries; please check your completed entry carefully.

Breed:		Call Name:	
Registered Name of Hound:			
Stake: <input type="checkbox"/> Open <input type="checkbox"/> FCH <input type="checkbox"/> Veteran <input type="checkbox"/> Single <input type="checkbox"/> Provisional		Additional Stakes <input type="checkbox"/> Kennel <input type="checkbox"/> Breeder <input type="checkbox"/> Bench	
Registration Number: (please write in registering body before number)			
<input type="checkbox"/> If possible, please separate my hounds	Date of Birth:	Sex: <input type="checkbox"/> Dog <input type="checkbox"/> Bitch	
Name of actual owner(s):			
Address:		Phone:	
City:		State:	Zip:
E-mail (Optional)		(Optional) Region of Residence:	
Emergency Contact Name and Phone (Optional)			
<input type="checkbox"/> Check if this is the first ASFA trial for this hound. Attach a Hound Certification or waiver if entered in Open, Veterans, Provisional.			
<input type="checkbox"/> Check if this is a first-time entry, a copy of the official Registration of this hound must accompany this entry unless NGA.			
<input type="checkbox"/> Check if any information has changed since the last ASFA trial entry. Regarding _____			
<input type="checkbox"/> Check if this hound has been dismissed within the last 6 trials entered. Must be marked in order to qualify for a "clean" trial requirement.			

I CERTIFY that I am the actual owner of this dog, or that I am the duly authorized agent of the actual owner whose name I have entered above. In consideration of the acceptance of this entry and the opportunity to have this dog judged and to win prize money, ribbons, or trophies, I (we) agree to abide by the rules and regulations of the American Sighthound Field Association in effect at the time of this lure field trial, and by any additional rules and regulations appearing in the premium list for this lure field trial. I (we) agree that the club holding this lure field trial has the right to refuse this entry for cause, which the club shall deem to be sufficient. I (we) agree to hold this club, its members, directors, governors, officers, agents or other functionaries, any employees of the aforementioned parties and the owner(s) of the trial premises or grounds harmless from any claim for loss or injury which may be alleged to have been caused directly or indirectly to any person or thing by the act of this dog while in or upon the lure field trial premises or grounds or near any entrance thereto and I (we) personally assume all responsibility and liability for any such claim, and I (we) further agree to hold the aforementioned parties harmless from any claim loss of this dog by disappearance, theft damage or injury be caused or alleged to be caused by the negligence of the club or any of the aforementioned parties or by the negligence of any person or any other cause or causes. I (we) certify and represent that the dog entered is not a hazard to person or other dogs. This entry is submitted for acceptance of the forgoing representations and agreements.

SIGNATURE of owner or his agent duly authorized to make this entry _____

Please separate the entries before submitting to FTS.

OFFICIAL AMERICAN SIGHTHOUND FIELD ASSOCIATION ENTRY FORM

GREATER TWIN CITIES WHIPPET CLUB **Septemer 21 & 22, 2024**

Entry Fees: \$20 first entry; \$17 second entry same household

Entries close **5PM, Wednesday, September 18, 2024**

Christine Canard 8132 Colfax Ave S. Bloomington, MN 55420

Make payment by check payable to GTCWC

Sunday 9/22/2024

Fee Paid _____ The Field Secretary cannot accept conditional, unsigned, incomplete, or unpaid entries; please check your completed entry carefully.

Breed:		Call Name:	
Registered Name of Hound:			
Stake: <input type="checkbox"/> Open <input type="checkbox"/> FCH <input type="checkbox"/> Veteran <input type="checkbox"/> Single <input type="checkbox"/> Provisional		Additional Stakes <input type="checkbox"/> Kennel <input type="checkbox"/> Breeder <input type="checkbox"/> Bench	
Registration Number: (please write in registering body before number)			
<input type="checkbox"/> If possible, please separate my hounds	Date of Birth:	Sex: <input type="checkbox"/> Dog <input type="checkbox"/> Bitch	
Name of actual owner(s):			
Address:		Phone:	
City:		State:	Zip:
E-mail (Optional)		(Optional) Region of Residence:	
Emergency Contact Name and Phone (Optional)			
<input type="checkbox"/> Check if this is the first ASFA trial for this hound. Attach a Hound Certification or waiver if entered in Open, Veterans, Provisional.			
<input type="checkbox"/> Check if this is a first-time entry, a copy of the official Registration of this hound must accompany this entry unless NGA.			
<input type="checkbox"/> Check if any information has changed since the last ASFA trial entry. Regarding _____			
<input type="checkbox"/> Check if this hound has been dismissed within the last 6 trials entered. Must be marked in order to qualify for a "clean" trial requirement.			

I CERTIFY that I am the actual owner of this dog, or that I am the duly authorized agent of the actual owner whose name I have entered above. In consideration of the acceptance of this entry and the opportunity to have this dog judged and to win prize money, ribbons, or trophies, I (we) agree to abide by the rules and regulations of the American Sighthound Field Association in effect at the time of this lure field trial, and by any additional rules and regulations appearing in the premium list for this lure field trial. I (we) agree that the club holding this lure field trial has the right to refuse this entry for cause, which the club shall deem to be sufficient. I (we) agree to hold this club, its members, directors, governors, officers, agents or other functionaries, any employees of the aforementioned parties and the owner(s) of the trial premises or grounds harmless from any claim for loss or injury which may be alleged to have been caused directly or indirectly to any person or thing by the act of this dog while in or upon the lure field trial premises or grounds or near any entrance thereto and I (we) personally assume all responsibility and liability for any such claim, and I (we) further agree to hold the aforementioned parties harmless from any claim loss of this dog by disappearance, theft damage or injury be caused or alleged to be caused by the negligence of the club or any of the aforementioned parties or by the negligence of any person or any other cause or causes. I (we) certify and represent that the dog entered is not a hazard to person or other dogs. This entry is submitted for acceptance of the forgoing representations and agreements.

SIGNATURE of owner or his agent duly authorized to make this entry _____

Please separate the entries before submitting to FTS.

OFFICIAL AMERICAN SIGHTHOUND FIELD ASSOCIATION LCI ENTRY FORM

GREATER TWIN CITIES WHIPPET CLUB September 21 & 22, 2024

Entries close 5PM, Wednesday, September 18, 2024

Entry Fees: \$20 first entry; \$17 second entry same household;

Make payment by check to GTCWC Entries limited to 20

Christine Canard 8132 Colfax Ave S. Bloomington, MN 55420

Saturday 9/21/2024

Fee Paid _____ The Field Secretary cannot accept conditional, unsigned, incomplete or unpaid entries; please check your completed entry carefully.

Breed:		Call Name:	
Registered Name of dog:			
Stake: <input type="checkbox"/> LCI-Small <input type="checkbox"/> LCI-Large <input type="checkbox"/> LCI-Sighthound Mix <input type="checkbox"/> Open <input type="checkbox"/> Excellent <input type="checkbox"/> Veteran			
Registration Number: (please write in registering body before number)			
Date of Birth:		Sex: <input type="checkbox"/> Dog <input type="checkbox"/> Bitch	
Name of actual owner(s):			
Address:		Phone:	
City:		State:	Zip:
E-mail		(Optional) Region of Residence:	
Emergency Contact Name and Phone (Optional)			
<input type="checkbox"/> Check if this is a first-time entry, a copy of the official Registration of this hound must accompany this entry. (i.e., AKC Registration form, PAL registration, Canine Partner, etc.)			
<input type="checkbox"/> Check if any information has changed since the last ASFA trial entry. Regarding _____			

I CERTIFY that I am the actual owner of this dog, or that I am the duly authorized agent of the actual owner whose name I have entered above. In consideration of the acceptance of this entry and the opportunity to have this dog judged and to win prize money, ribbons, or trophies, I (we) agree to abide by the rules and regulations of the American Sighthound Field Association in effect at the time of this lure field trial, and by any additional rules and regulations appearing in the premium list for this lure field trial. I (we) agree that the club holding this lure field trial has the right to refuse this entry for cause, which the club shall deem to be sufficient. I (we) agree to hold this club, its members, directors, governors, officers, agents or other functionaries, any employees of the aforementioned parties and the owner(s) of the trial premises or grounds harmless from any claim for loss or injury which may be alleged to have been caused directly or indirectly to any person or thing by the act of this dog while in or upon the lure field trial premises or grounds or near any entrance thereto and I (we) personally assume all responsibility and liability for any such claim, and I (we) further agree to hold the aforementioned parties harmless from any claim loss of this dog by disappearance, theft damage or injury be caused or alleged to be caused by the negligence of the club or any of the aforementioned parties or by the negligence of any person or any other cause or causes. I (we) certify and represent that the dog entered is not a hazard to person or other dogs. This entry is submitted for acceptance of the forgoing representations and agreements.

SIGNATURE of owner or his agent duly authorized to make this entry _____

Please separate the entries before submitting to FTS.

EF-A ~ rev 01/20 ©

OFFICIAL AMERICAN SIGHTHOUND FIELD ASSOCIATION LCI ENTRY FORM

GREATER TWIN CITIES WHIPPET CLUB September 21 & 22, 2024

Entries close 5PM, Wednesday, September 18, 2024

Entry Fees: \$20 first entry; \$17 second entry same household;

Make payment by check to GTCWC Entries limited to 20

Christine Canard 8132 Colfax Ave S. Bloomington, MN 55420

Sunday 9/22/2024

Fee Paid _____ The Field Secretary cannot accept conditional, unsigned, incomplete or unpaid entries; please check your completed entry carefully.

Breed:		Call Name:	
Registered Name of dog:			
Stake: <input type="checkbox"/> LCI-Small <input type="checkbox"/> LCI-Large <input type="checkbox"/> LCI-Sighthound Mix <input type="checkbox"/> Open <input type="checkbox"/> Excellent <input type="checkbox"/> Veteran			
Registration Number: (please write in registering body before number)			
Date of Birth:		Sex: <input type="checkbox"/> Dog <input type="checkbox"/> Bitch	
Name of actual owner(s):			
Address:		Phone:	
City:		State:	Zip:
E-mail		(Optional) Region of Residence:	
Emergency Contact Name and Phone (Optional)			
<input type="checkbox"/> Check if this is a first-time entry, a copy of the official Registration of this hound must accompany this entry. (i.e., AKC Registration form, PAL registration, Canine Partner, etc.)			
<input type="checkbox"/> Check if any information has changed since the last ASFA trial entry. Regarding _____			

I CERTIFY that I am the actual owner of this dog, or that I am the duly authorized agent of the actual owner whose name I have entered above. In consideration of the acceptance of this entry and the opportunity to have this dog judged and to win prize money, ribbons, or trophies, I (we) agree to abide by the rules and regulations of the American Sighthound Field Association in effect at the time of this lure field trial, and by any additional rules and regulations appearing in the premium list for this lure field trial. I (we) agree that the club holding this lure field trial has the right to refuse this entry for cause, which the club shall deem to be sufficient. I (we) agree to hold this club, its members, directors, governors, officers, agents or other functionaries, any employees of the aforementioned parties and the owner(s) of the trial premises or grounds harmless from any claim for loss or injury which may be alleged to have been caused directly or indirectly to any person or thing by the act of this dog while in or upon the lure field trial premises or grounds or near any entrance thereto and I (we) personally assume all responsibility and liability for any such claim, and I (we) further agree to hold the aforementioned parties harmless from any claim loss of this dog by disappearance, theft damage or injury be caused or alleged to be caused by the negligence of the club or any of the aforementioned parties or by the negligence of any person or any other cause or causes. I (we) certify and represent that the dog entered is not a hazard to person or other dogs. This entry is submitted for acceptance of the forgoing representations and agreements.

SIGNATURE of owner or his agent duly authorized to make this entry _____

Please separate the entries before submitting to FTS.

EF-A ~ rev 01/20 ©

**AMERICAN SIGHTHOUND FIELD ASSOCIATION
HOUND CERTIFICATION**

Rule effective October 1, 1994: Ch. V, Sec. 4 (a) OPEN STAKE: *To be eligible to enter the open stake, a hound must have been certified by a licensed judge within the year preceding the closing date for the entry or have previously competed in the Open Stake.* This eligibility requirement also applies to a hound entered in the Veteran Stake, which has not competed in Open previously. Please complete this portion of this form and attach it to the entry form for the hound's first entry, including an entry for a Fun Trial.

Registered Name of Hound: _____

Registration Number: _____ Breed: _____

Registered Owner's Name: _____

I hereby certify that on (date) _____, the above named hound completed a lure course of at least 500 yards, running with another hound of the same breed (or another breed with a similar running style). During the course the above named hound showed no inclination to interfere with the other hound. I further certify that I am a licensed judge for the ASFA.

Name of Licensed Judge: _____

Signature: _____ Date: _____

I hereby certify that the hound running in the certification course is the hound identified above and that information provided on this form is true and correct.

Signature: _____ Date: _____

Owner or Authorized Agent of Hound

This certification form must be attached to the entry form the first time this hound is entered in an open or veteran stake. Any hound entered in open, or veteran (as a first time entered hound), which has not been certified, shall be declared ineligible by the records coordinator and shall forfeit any points and placements awarded.

PLEASE RETAIN A COPY FOR YOUR RECORDS.

**AMERICAN SIGHTHOUND FIELD ASSOCIATION
HOUND CERTIFICATION WAIVER**

Waiver of Requirement: *This requirement will be waived for a hound that has earned a lure coursing title from another recognized organization, if such title requires competition, and if a waiver for such title has been approved by the ASFA, or a CKC Hound Certification Form.* If your hound qualifies for a waiver, complete this portion of this form and attach it to your entry form. Proof of waivers must accompany this certification form.

Registered Name of Hound: _____

Registration Number: _____ Breed: _____

Registered Owner's Name: _____

CKC: FCH FCHX

AKC: QC SC FC

Hound Certification previously submitted.

I hereby certify that the hound identified above has completed the requirements for the title indicated above (or that the required Certification was previously submitted) and that the information provided on this form is true and correct.

Signature: _____ Date: _____

Owner or Authorized Agent of Hound

**AMERICAN SIGHTHOUND FIELD ASSOCIATION
HOUND CERTIFICATION**

Rule effective October 1, 1994: Ch. V, Sec. 4 (a) OPEN STAKE: *To be eligible to enter the open stake, a hound must have been certified by a licensed judge within the year preceding the closing date for the entry or have previously competed in the Open Stake.* This eligibility requirement also applies to a hound entered in the Veteran Stake, which has not competed in Open previously. Please complete this portion of this form and attach it to the entry form for the hound's first entry, including an entry for a Fun Trial.

Registered Name of Hound: _____

Registration Number: _____ Breed: _____

Registered Owner's Name: _____

I hereby certify that on (date) _____, the above named hound completed a lure course of at least 500 yards, running with another hound of the same breed (or another breed with a similar running style). During the course the above named hound showed no inclination to interfere with the other hound. I further certify that I am a licensed judge for the ASFA.

Name of Licensed Judge: _____

Signature: _____ Date: _____

I hereby certify that the hound running in the certification course is the hound identified above and that information provided on this form is true and correct.

Signature: _____ Date: _____

Owner or Authorized Agent of Hound

This certification form must be attached to the entry form the first time this hound is entered in an open or veteran stake. Any hound entered in open or veteran (as a first time entered hound), which has not been certified, shall be declared ineligible by the records coordinator and shall forfeit any points and placements awarded.

PLEASE RETAIN A COPY FOR YOUR RECORDS.

**AMERICAN SIGHTHOUND FIELD ASSOCIATION
HOUND CERTIFICATION WAIVER**

Waiver of Requirement: *This requirement will be waived for a hound that has earned a lure coursing title from another recognized organization, if such title requires competition, and if a waiver for such title has been approved by the ASFA, or a CKC Hound Certification Form.* If your hound qualifies for a waiver, complete this portion of this form and attach it to your entry form. Proof of waivers must accompany this certification form.

Registered Name of Hound: _____

Registration Number: _____ Breed: _____

Registered Owner's Name: _____

CKC: FCH FCHX

AKC: QC SC FC

Hound Certification previously submitted.

I hereby certify that the hound identified above has completed the requirements for the title indicated above (or that the required Certification was previously submitted) and that the information provided on this form is true and correct.

Signature: _____ Date: _____

Owner or Authorized Agent of Hound

Request for ASFA Lure Chasing Instinct Registration Number

Fee Paid _____ This form is for dogs without any registration number from another registering body.
Please print legibly.

Breed:	Call Name:		
Registered Name of Dog:			
FTS will circle Size after wicketing at Inspection:			
Size Small: up to 17½ inches (or brachycephalic)		Size Large: over 17½ inches	
Registration Number: (To be assigned by ASFA records coordinator.)			
Date of Birth:	Sex: <input type="checkbox"/> Dog <input type="checkbox"/> Bitch		
Name of actual owner(s):			
Address:		Phone:	
City:	State:	Zip:	
E-mail	Region of Residence: (Optional)		
Emergency Contact Name and Phone			

This top portion is to be submitted with the \$10 fee to the Field Trial Secretary. First time trial entry on separate form.

_____ was entered in the _____
 (Dog's Name) (ASFA Club Name)

ASFA trial held on _____. The dog was wicketed at inspection and is
 registered as Size _____ (Date). The fee of \$10 was received by the FTS and
 submitted to the ASFA Records Coordinator.

 Printed name of Field Trial Secretary

 Signature of Field Trial Secretary

(Owner is to retain this receipt as proof of registration until notified by the ASFA.)

Request for ASFA Lure Chasing Instinct Registration Number

Fee Paid _____ This form is for dogs without any registration number from another registering body.
Please print legibly.

Breed:	Call Name:		
Registered Name of Dog:			
FTS will circle Size after wicketing at Inspection:			
Size Small: up to 17½ inches (or brachycephalic)		Size Large: over 17½ inches	
Registration Number: (To be assigned by ASFA records coordinator.)			
Date of Birth:	Sex: <input type="checkbox"/> Dog <input type="checkbox"/> Bitch		
Name of actual owner(s):			
Address:		Phone:	
City:	State:	Zip:	
E-mail	Region of Residence: (Optional)		
Emergency Contact Name and Phone			

This top portion is to be submitted with the \$10 fee to the Field Trial Secretary. First time trial entry on separate form.

_____ was entered in the _____
 (Dog's Name) (ASFA Club Name)

ASFA trial held on _____. The dog was wicketed at inspection and is
 registered as Size _____ (Date). The fee of \$10 was received by the FTS and
 submitted to the ASFA Records Coordinator.

 Printed name of Field Trial Secretary

 Signature of Field Trial Secretary

(Owner is to retain this receipt as proof of registration until notified by the ASFA.)

ENTRY FEE TABLE

Entries	Total for 1 day	Total for 2 days
1st	\$20	\$40
2nd	\$37	\$74
3 rd	\$54	\$108
4th	\$71	\$142
5th	\$88	\$176

PRACTICES & HOUND CERTIFICATIONS Except for Hounds entered in Singles Stake that may certify before the trial, certs & hound practices will be available after the trial on **Saturday** (weather, equipment & field conditions permitting). The fee for a certification run is \$5. Make arrangements for a hound to run with, and have the proper form for the judge to sign. Certifications will be run before practice runs as a courtesy to the judges.

REFUNDS - GTCWC provides refunds of entry fees for dogs that are in season or lame, so long as the Field Trial Secretary is notified of the situation **before roll call**. If your dog comes in season or becomes lame before the Trial, and you will not be attending the Trial for that reason, you must notify the Field Trial Secretary **BEFORE** roll to claim a refund. If the Field Trial Secretary does not receive notice before roll call, GTCWC will not issue a refund.

Volunteers

The GTCWC needs your help to make this and all our trials happen. Please plan to volunteer!

For GTCWC Members

If your hound is eligible to compete for the Karen Samuelson Memorial Trophy for 2024, please include a copy of your hound's registration along with your trial entry if you didn't submit it with your May entries. This club trophy is awarded at our annual meeting awarding the trophy to the whippet defeating the highest number of other whippets, both owned and bred by a GTCWC member with dues paid by March 1st, 2024.

LUNCH

The GTCWC will be providing sub sandwiches from Subway for Saturday lunch. Please bring a pot luck item to share. Sunday lunch is on your own. Subway, Dairy Queen & McDonalds are nearby.

